

INDIAN INSTITUTE OF TECHNOLOGY, KANPUR
Advanced Imaging Centre

Enquiry No: IMGC/2016-17/JUNE /01

Enquiry Date :17.06.2016

Opening Date: 17/06/2016

Closing date: 01 /07/2016

Sealed Quotations are invited for our Advanced Imaging Centre. Detailed specifications, term and conditions and lay of the slabs are mentioned below" A rough drawing has been attached for reference.

TECHNICAL SPECIFICATIONS

S.No.	ITEM DESCRIPTIONS	QTY	UNIT
1	46mm T shape workstation in the size 1500x1500x600x600 with mobile pedestal	04 No.	Nos
2	46mm cabin the size 3600x1800 with table in the size 1800x750x750 with ERU in size 900x600 with back storage in the size 1800x450x750 with pedestal	01 No.	Nos

Terms and conditions:

1. The samples, wherever asked for, will not be paid for. These should be delivered in the office of the undersigned, securely labelled. The liability of to and fro freight is vendor responsibility, if applicable and should be pre-paid.
2. Warranty: not less than three (03) years after installation
3. Quotation must be valid for 90 days.
4. All prices are to be FOR IIT Kanpur.
5. Vendor should have authorised local service in Kanpur.
6. The final delivery period should not be more than 4 weeks. The institute is exempted for payment of Excise duty under notification No. 10/97 & partially custom duty (@5.15%), under notification 51/96 and a road permit will be provided, if applicable. The Concessional Form 'C/D' have been abolished w. e. f. Apr 01, 2007.
7. Our standard payment terms and conditions is 90% on installation and 10% after inspection and approval.
8. The Penalty @1% per week or part thereof subject to max 10% of the delivery price will be deducted from the balance payment, if supply is not completed within stipulated period.
9. All quotes should be Indian Rupees.
10. Quotations should carry proper certifications such as, agency certificates, proprietary
11. The number of work station may increase or decrease, while ordering.
12. All quotation must reach undersigned on or before **01/07/2016 at 1500 hrs.**

Kindly send us detail Quotations for the same keeping in mind that I.I.T Kanpur is an educational Institution not a profit earning organization please quote as minimum as possible.

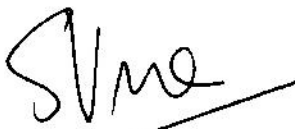

Prof. Sandeep Verma
Coordinator
Advanced Imaging
Indian Institute of Technology, Kanpur-208016

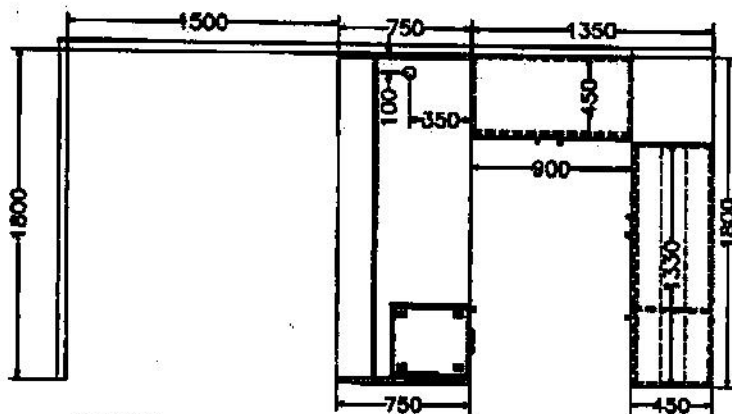

TOP VIEW

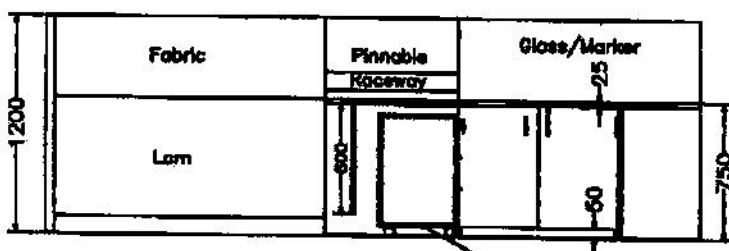

FRONT VIEW

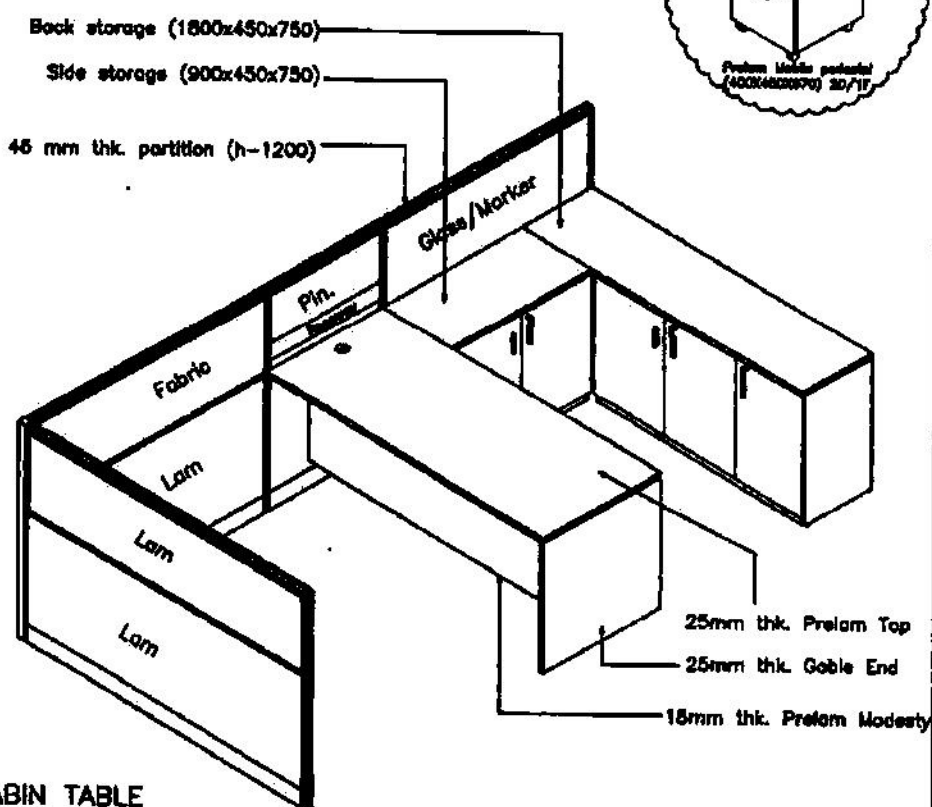
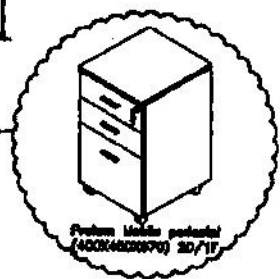

ISOMERIC VIEW

CUBICAL CABIN TABLE
(1800X750X750) QTY-1

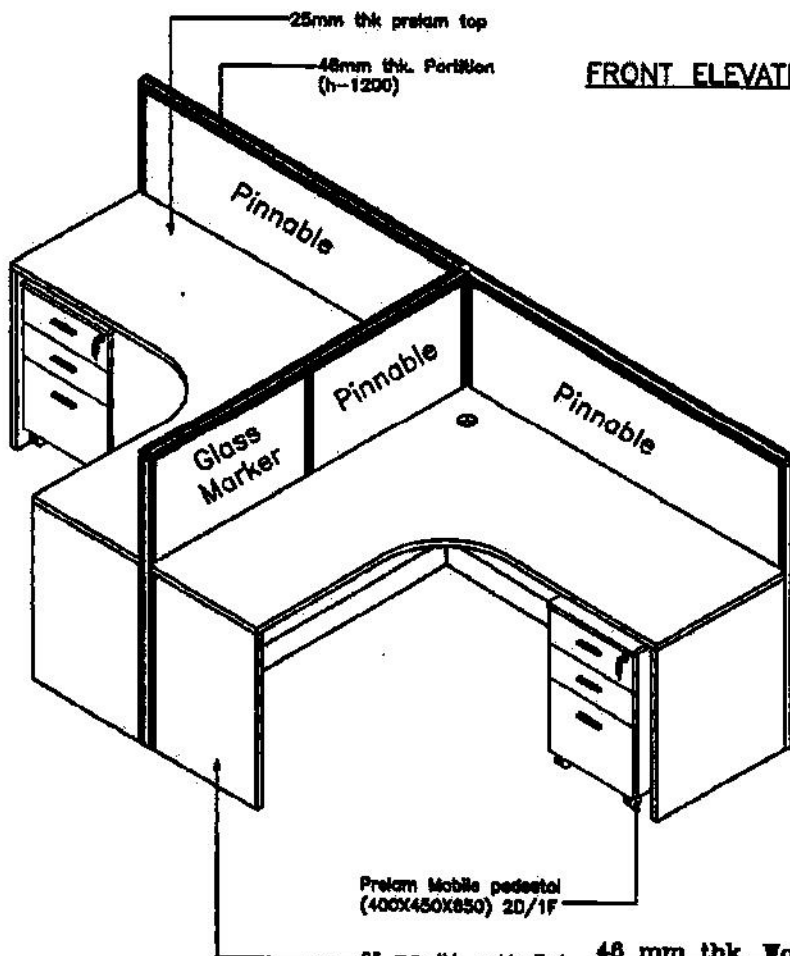
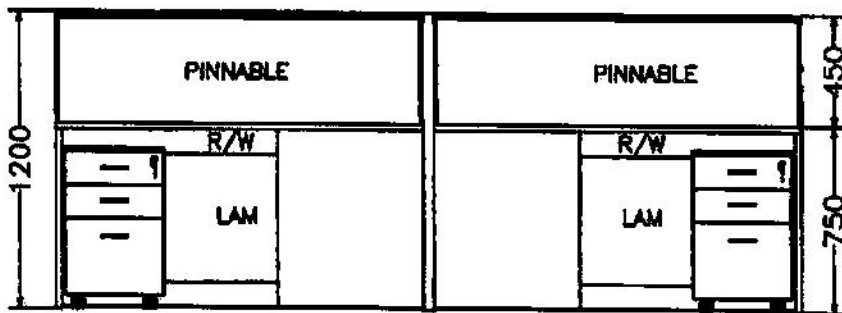
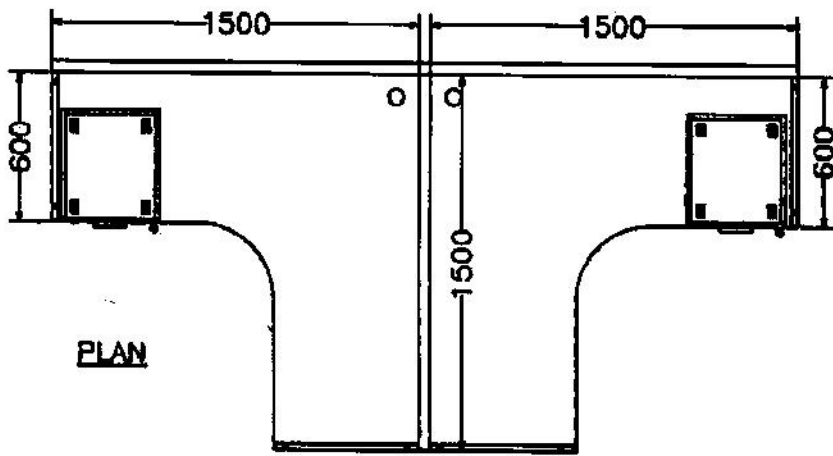

FRONT ELEVATION

ISOMETROC

**48 mm thk. Workstation
(1500x1500x800x1200)
Set - 2**